

FIRST FLOOR
421 sq.ft. (39.1 sq.m.) approx.

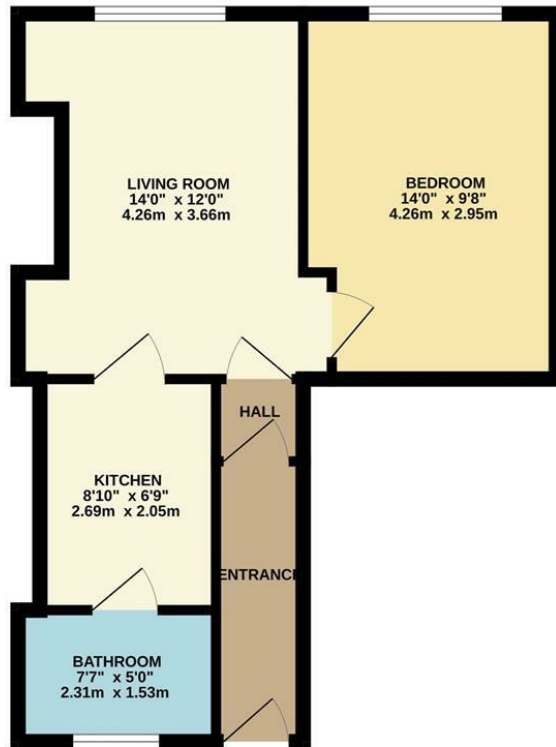

TOTAL FLOOR AREA: 421 sq.ft. (39.1 sq.m.) approx.
Whilst every attempt has been made to ensure the accuracy of the floorplan contained here, measurements of doors, windows, rooms and any other items are approximate and no responsibility is taken for any error, omission or mis-statement. This plan is for illustrative purposes only and should be used as such by any prospective purchaser. The services, systems and appliances shown have not been tested and no guarantee as to their operability or efficiency can be given.
Made with Metropix ©2023

47 Bedford Street, Leamington Spa
£1,050 Per Month

charlesrose.



A modern firstfloor apartment in a highly convenient central Leamington location.

This well-presented property offers a private entrance hallway, a spacious lounge, a double bedroom, a fitted kitchen with brand-new appliances, and a contemporary shower room. Residents also benefit from access to a communal roof terrace.

Ideally suited to a single professional.

Please note: no parking available.

Available from: 9th February 2026

Holding Deposit: £150
Security Deposit: £1200

EPC: To be confirmed
Council Tax Band: A

charlesrose.

- 01926 832411
- hello@charlesrose.co.uk
- charlesrose.co.uk

